

# Parent Guide

## How can I use this with my children?

Select the level suitable for your child – one, two or three stars – and print the appropriate sheets. Ask your child to read the question then write their answers. Check using the answer sheet.

## How does this help my children's learning?

These activity sheets are a good way to encourage your child to use their knowledge of the 24-hour clock in a real-life context, allowing them to work out journey times and durations from a timetable.

## Ideas for further learning:

Collect local timetables when you're out and about or download examples from the internet. Ask your child to plan a day out using the journey times given, making sure you will be home by a set time.



# Train Timetable Questions

Destination	Journey A	Journey B	Journey C
London	10:20	11:30	16:40
Derby	12:20		18:00
Sheffield	12:40	13:10	18:30
York	13:20	13:55	19:15
Newcastle	14:25	14:40	
Duration			3 hours

1. Journey B takes 1 hour to get from London to Derby. What time do you arrive at Derby?

\_\_\_\_\_

2. Journey C takes a total of 3 hours, what time does it arrive at Newcastle?

\_\_\_\_\_

3. How long does journey A take? \_\_\_\_\_

4. You need to be at York for 13:30. Which is the best journey to take?

\_\_\_\_\_

5. You arrive at Sheffield train station at 18:10. How long do you have to wait for the next train to Newcastle? \_\_\_\_\_

6. How many stations does the 11:30 train stop at before it reaches York?

\_\_\_\_\_

# Train Timetable Questions

	Sunday Train Times		
Destination	Journey A	Journey B	Journey C
London	12:20	13:30	18:40
Derby			
Sheffield			
York			
Newcastle			
Duration			

- Sunday trains run exactly 2 hours later than the rest of the week. Fill in the timetable above.
- Create your own train timetable with three journeys. Use your own stations and times.

Destination	Journey ___	Journey ___	Journey ___

# Train Timetable Questions

Destination	Journey A	Journey B	Journey C
London	10:15	11:30	16:40
Derby	12:15		18:05
Sheffield	12:40	13:10	18:30
York	13:20	13:55	19:15
Newcastle	14:05	14:35	
Duration			3 hours

1. Journey B takes 1 hour 15 minutes to get from London to Derby. What time do you arrive at Derby? \_\_\_\_\_
2. Journey C takes a total of 3 hours, what time does it arrive at Newcastle?  
\_\_\_\_\_
3. How long do journeys A and B take? \_\_\_\_\_
4. You need to be at York for 13:30. Which is the best journey to take?  
\_\_\_\_\_
5. You get to Sheffield at 16:50. How long do you have to wait for the next train to Newcastle? \_\_\_\_\_
6. How many stations does the 11:30 train stop at before it reaches York?  
\_\_\_\_\_

# Train Timetable Questions

Destination	Journey D	Journey E	Journey F
London	22:15	23:30	04:40
Derby			
Sheffield			
York			
Newcastle			
Duration			

7. Journeys D, E and F run exactly 12 hours later than journeys A, B and C. Fill in the timetable above

8. Create your own train timetable with three journeys. Use your own stations and times.

Destination	Journey ____	Journey ____	Journey ____

# Train Timetable Questions

Destination	Journey A	Journey B	Journey C
London	10:17	11:37	16:43
Derby	12:12		18:08
Sheffield	12:38	13:08	18:27
York	13:16	13:58	19:14
Newcastle	14:06	14:34	
Duration			3 hours and 5 minutes

1. Journey B takes 1 hour and 16 minutes to get from London to Derby. What time do you arrive at Derby? \_\_\_\_\_
2. Journey C takes a total of 3 hours and 5 minutes, what time does it arrive at Newcastle?  
\_\_\_\_\_
3. How long do journeys A and B take? \_\_\_\_\_  
What is the difference in time? \_\_\_\_\_
4. You need to be at York for an appointment at 14:30. Which is the best journey to take?  
\_\_\_\_\_  
How much spare time will you have in York before your appointment?  
\_\_\_\_\_
5. You arrive at Sheffield train station at 16:50. How long do you have to wait for the next train to Newcastle? \_\_\_\_\_
6. How many stations does the 11:37 train stop at before it reaches York?  
\_\_\_\_\_

# Train Timetable Questions

Destination	Journey D	Journey E	Journey F
London			
Derby			
Sheffield			
York			
Newcastle			
Duration			

7. Journeys D, E and F run exactly 11 hours 35 minutes later than journeys A, B and C. Fill in the timetable above.

8. Create your own train timetable with three journeys. Use your own stations and times.

Destination	Journey ____	Journey ____	Journey ____

# Train Timetable Questions - Answers

1. 12:30
2. 19:40
3. 4 hours and 5 minutes
4. Journey A
5. 20 minutes
6. 2 stations
- 7.

	Sunday Train Times		
Destination	Journey A	Journey B	Journey C
London	12:20	13:30	18:40
Derby	14:20	14:30	20:00
Sheffield	14:40	15:10	20:30
York	15:20	15:55	21:15
Newcastle	16:25	16:40	21:40
Duration	4 hours and 5 minutes	3 hours and 10 minutes	3 hours

8. Accept any reasonable answer



# Train Timetable Questions - Answers

1. 12:45
2. 19:40
3. Journey A = 3 hours and 50 minutes  
Journey B = 3 hours and 5 minutes
4. Journey A
5. 1 hour 40 minutes
6. 2 stations
- 7.

Destination	Journey D	Journey E	Journey F
London	22:15	23:30	04:40
Derby	00:15	00:45	06:05
Sheffield	00:40	01:10	06:30
York	01:20	01:55	07:15
Newcastle	02:05	02:35	07:40
Duration	3 hours and 10 minutes	3 hours and 5 minutes	3 hours

8. Accept any reasonable answer

# Train Timetable Questions - Answers

- 12:53
- 19:48
- Journey A = 3 hours and 49 minutes  
Journey A = 2 hours and 57 minutes  
Difference in time = 52 minutes
- Journey A or B  
Journey A = 1 hour and 14 minutes  
Journey B = 32 minutes
- 1 hour and 37 minutes
- 2 stations
- 

Destination	Journey D	Journey E	Journey F
London	21:52	23:12	04:18
Derby	23:47	00:28	05:43
Sheffield	00:13	00:43	06:02
York	00:51	01:33	06:49
Newcastle	01:41	02:09	07:23
Duration	3 hours and 49 minutes	2 hours and 55 minutes	3 hours and 5 minutes

- Accept any reasonable answer

If you enjoyed this resource, why not try...

Train Time  
Word Problems  
Worksheet

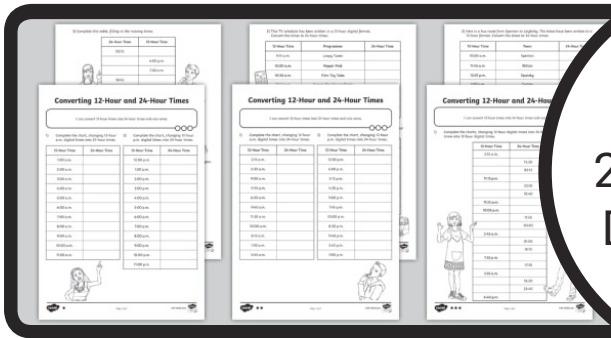
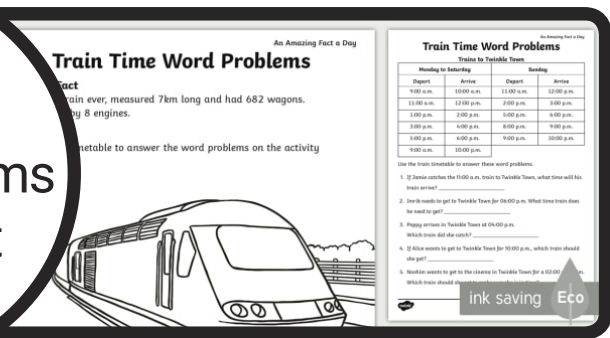

Converting  
12-Hour and  
24-Hour Clock  
Differentiated  
Worksheets

Time Word  
Problems  
Cards

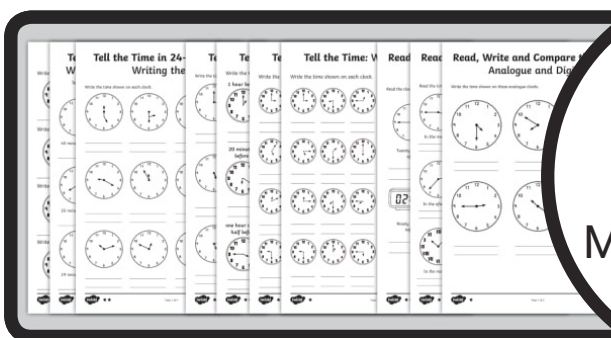
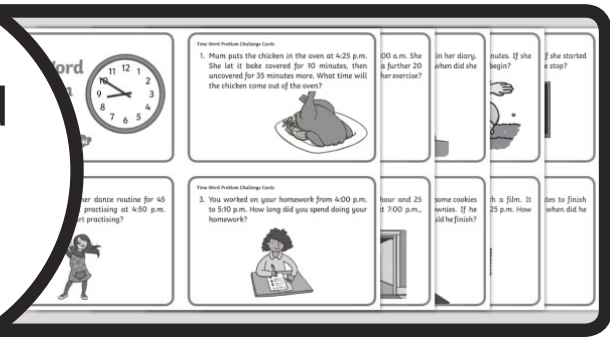

Tell the Time  
Differentiated  
Worksheets  
Maths Resource  
Pack

If you need us, just get in touch -  
contact [twinklcares@twinkl.co.uk](mailto:twinklcares@twinkl.co.uk)  
visit [twinkl.com/parents](http://twinkl.com/parents)

Explore and Discover More

